



**LANDSCAPE NOTES:**

- ALL WORK TO BE CARRIED OUT IN ACCORDANCE WITH BY-LAWS AND CODES HAVING JURISDICTION OVER SITE LOCATION.
- COMPLETE ALL WORK TO THE SATISFACTION OF THE LANDSCAPE ARCHITECT.
- REPORT ANY CHANGES, DISCREPANCIES OR SUBSTITUTIONS TO THE LANDSCAPE ARCHITECT BEFORE PROCEEDING.
- IT IS THE CONTRACTOR'S RESPONSIBILITY TO DETERMINE EXISTING SERVICE LOCATIONS.
- EXACT LOCATIONS OF PLANT MATERIAL WILL BE DETERMINED BY PLACEMENT OF SITE SERVICES SUCH AS HYDRO VALVES, METERS, UTILITIES, ROOF RAIN WATER LEADERS, DRIVEWAYS, LIGHT STANDARDS, ETC.
- ALL PLANT MATERIAL LOCATIONS TO BE STAKED OR MARKED OUT AND APPROVED BY LANDSCAPE ARCHITECT PRIOR TO INSTALLATION.
- SUPPLY ALL PLANT MATERIAL IN ACCORDANCE WITH THE CANADIAN STANDARDS FOR NURSERY STOCK (8th Ed.).
- INSTALL PLANT MATERIAL ACCORDING TO DETAILS SHOWN.
- DISTURBED SOIL AREAS AROUND TREES AND SHRUBS ARE TO BE COVERED WITH SHREDDED CONIFER BARK MULCH SUCH AS CANADA RED OR 'GRO-BARK' SPM MULCH, OR APPROVED EQUIVALENT. ALTERNATIVE MULCHES MUST BE APPROVED BY THE LANDSCAPE ARCHITECT.
- CONTRACTOR TO UTILIZE LAYOUT DIMENSIONS WHERE PROVIDED.
- PROVIDE PLANTING BED AREA AS NOTED ON THE DRAWING OR TO ACCOMMODATE MATURE SIZE OF PLANT MATERIAL.
- ALL SUPPORT SYSTEMS MUST BE REMOVED BY THE CONTRACTOR AT TIME OF FINAL ACCEPTANCE. NO EXTRAS WILL BE PAID TO COMPLETE THIS WORK.
- SUPPLY AND PLACE TOPSOIL IN ACCORDANCE WITH OPSS 802 TO A MINIMUM DEPTH OF 150mm UNLESS OTHERWISE SPECIFIED.
- SUPPLY AND PLACE SOD IN ACCORDANCE WITH OPSS 803 UNLESS OTHERWISE SPECIFIED.
- SUPPLY AND PLACE SEED IN ACCORDANCE WITH OPSS 804 UNLESS OTHERWISE SPECIFIED. ALL 5:1 OR GREATER SLOPES TO BE SEEDED WITH TACIFIER. CONTRACTOR TO PROVIDE NECESSARY EROSION CONTROL PROTECTION AS REQUIRED TO ENSURE SOIL STABILIZATION AND PROPER SEED GERMINATION.
- ALL DIMENSIONS IN METRES UNLESS OTHERWISE NOTED.
- IF DISCREPANCIES ARISE BETWEEN PLANT MATERIAL COUNT SHOWN ON DRAWINGS AND PLANT LIST, THE DRAWING SHALL BE CONSIDERED CORRECT.
- CONTRACTOR TO PROVIDE MINIMUM TWO (2) YEAR WARRANTY FROM DATE ACCEPTED ON ALL WORK UNLESS OTHERWISE SPECIFIED.
- ANY SITE PLAN OR GRADING AND SERVICING SHOWN IS FOR INFORMATION ONLY. REFER TO APPROVED DRAWINGS.
- NOT FOR CONSTRUCTION UNLESS STAMPED, SIGNED AND DATED BY LANDSCAPE ARCHITECT.
- DRAWINGS NOT TO BE REPRODUCED WITHOUT WRITTEN CONSENT FROM LANDSCAPE ARCHITECT.
- APPROVAL OF LANDSCAPE PLAN TO BE OBTAINED FROM MUNICIPALITY.
- FOR GRADING AND SERVICING INFORMATION REFER TO THE ENGINEERS DRAWINGS.
- FOR LIGHTING INFORMATION AND POWER DISTRIBUTION REFER TO THE ELECTRICAL DRAWINGS.

**PLANT SCHEDULE**

KEY	BOTANICAL NAME	COMMON NAME	CAL.	SIZE	COND	MATURE HEIGHT (m)	MATURE SPREAD (m)	O.C. SPACING (m)	QNTY.	%
<b>SHRUBS</b>										
Cs	<i>Cornus sericea</i>	Red Osier Dogwood		30cm	#3 cont	2.5	3.0	1.5	9	
<b>PERENNIALS/ GRASSES/ VINES</b>										
ca	<i>Calamagrostis x acutifolia</i> Karl Foerster	Feather Reed Grass			#1 cont	1.2	1.0	1.0	61	
ep	<i>Echinacea purpurea</i>	Purple Coneflower			#1 cont	0.9	0.6	0.5	11	

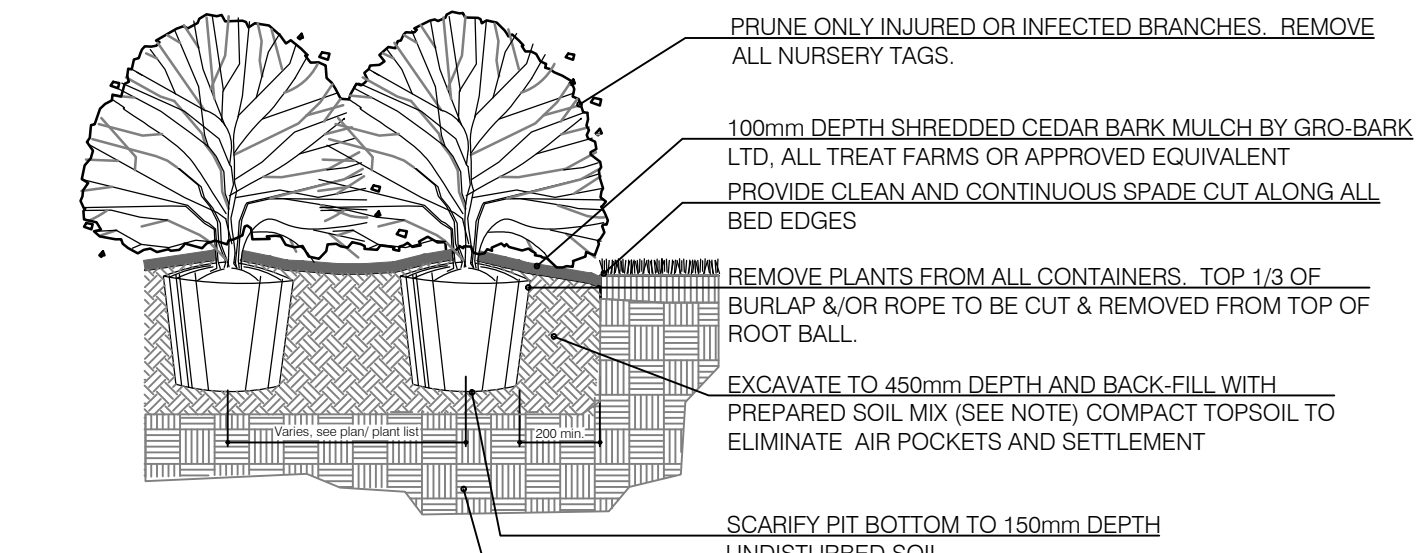

- NOTES:**
- SOIL MIXTURE: FOUR (4) PARTS NATIVE SOIL, ONE (1) PART WELL ROTTED COMPOST.
  - SAUCER SHALL BE SOAKED WITH WATER AND MULCHED IMMEDIATELY FOLLOWING PLANTING.
  - ALL DIMENSIONS ARE IN mm.
  - IN POORLY DRAINED SOILS PLANT SHRUB SLIGHTLY HIGHER THAN ADJACENT GRADE.
  - ALL PLANTS TO BE STRAIGHT AND PLANTED VERTICALLY REGARDLESS OF SLOPE.

**1 BALLED AND BURLAPPED/POTTED SHRUB**  
N.T.S.

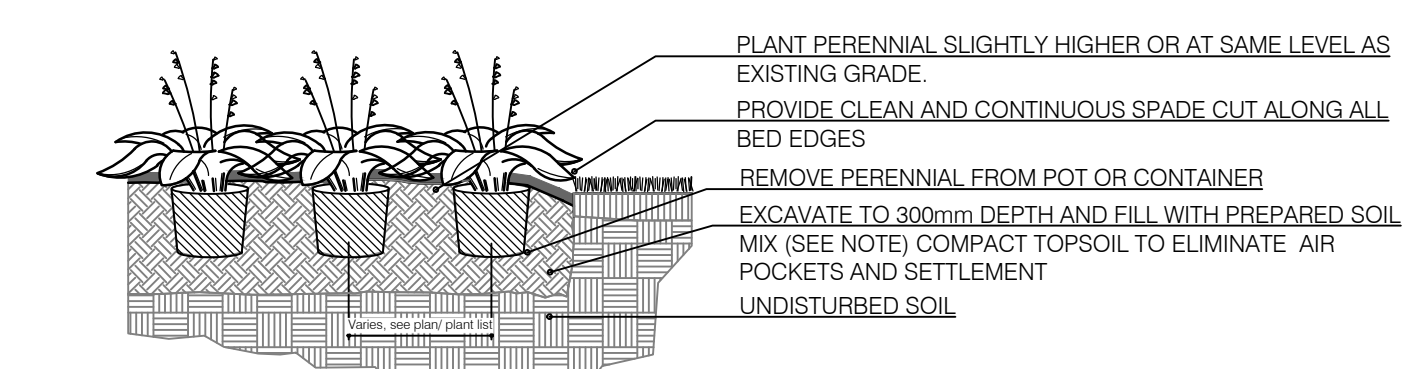

- NOTES:**
- SOIL MIXTURE: FOUR (4) PARTS NATIVE SOIL, ONE (1) PART WELL ROTTED COMPOST.
  - SAUCER SHALL BE SOAKED WITH WATER AND MULCHED IMMEDIATELY FOLLOWING PLANTING.
  - ALL DIMENSIONS ARE IN mm.
  - CUT AND REMOVE CONTAINER. SCARIFY ROOTBALL SIDES.
  - ALL PLANTS TO BE STRAIGHT AND PLANTED VERTICALLY REGARDLESS OF SLOPE.
- CONTRACTOR SHALL PROVIDE 75mm MULCH FOR ALL PERENNIALS EXCEPT GROUNDCOVERS UNLESS SPECIFIED OTHERWISE.

**2 CONTAINER GROWN PERENNIAL/GRASS**  
N.T.S.

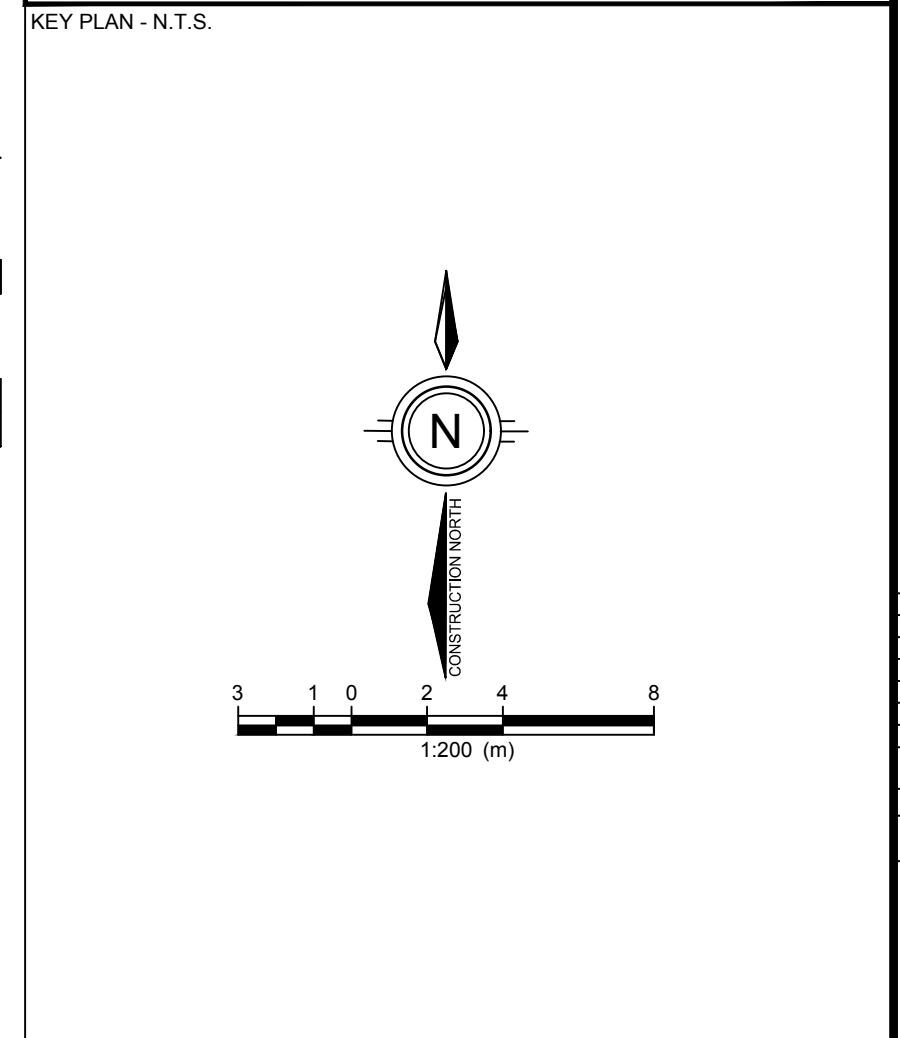
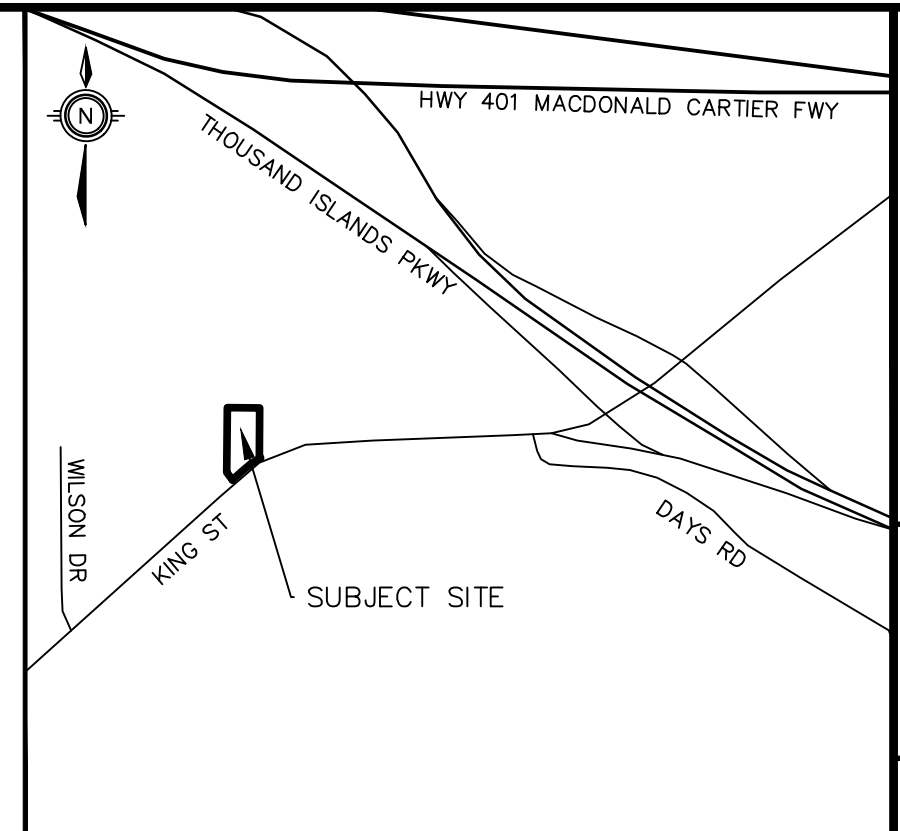

**LEGEND**

- Proposed Deciduous Shrubs
- Proposed Perennials
- Proposed Ornamental Grasses
- Topsoil and Sod as Specified Minimum 150mm Topsoil Depth
- Limit of Work

**NOT FOR CONSTRUCTION**

**CLIENT**

McDonald's Restaurants of Canada Ltd.  
4400 Still Creek Drive  
Burnaby, BC  
V5C 6C8  
Tel: 604-294-2181

**COPYRIGHT**  
Any reproduction or distribution for any purpose other than authorized by IBI Group is forbidden. Written dimensions shall have precedence over scaled dimensions. Contractors shall verify and be responsible for all dimensions and conditions on the job and IBI Group shall be informed of any variations from the dimensions and conditions shown on the drawing. Shop drawings shall be submitted to IBI Group for approval before proceeding with fabrication.

Copyright © 2021  
IBI GROUP PROFESSIONAL SERVICES (CANADA) INC.

DATE	BY	DESCRIPTION
21-04-28	CM	ISSUED FOR REVIEW
<b>DRAWING ISSUE RECORD</b>		

**SEALS**

**SUB-CONSULTANT**

**PRIME CONSULTANT**

**IBI GROUP**  
200-360 James Street North  
Hamilton ON L8L 1H5 Canada  
tel 905 546 1010  
ibigroup.com

**PROJECT**  
**McDONALD'S**  
**21611-GANANOQUE**  
670 KING STREET, GANANOQUE

**PROJECT NO:** 126533  
**DRAWN BY:** CM  
**CHKD BY:** TO  
**SCALE:** 1:200  
**DATE:** 21-04-15

**SHEET TITLE**  
**LANDSCAPE PLAN**

**L1.0**

SHEET 1 OF 1